



XK8

DATE 2/97

206-03

SERVICE

TECHNICAL BULLETIN

Incorrect Torque Specification – Front & Rear Brake Caliper Retaining Bolts & Guide Pins

MODEL 1997 MY-ON XK8 Range
VIN 001001-ON

Issue:

The torque specifications for the caliper carrier retaining bolts and the guide pins are incorrect in the XK8 Vehicle Service Manual (VSM), Section 206, dated 08-96.

Action:

The following torque values apply during any Service Repair Operation in which brake caliper dismantling, removal and refitting, or brake pad renewal, are performed.

These amendments to torque figures and terminology will be included in the next issue of the Vehicle Service Manual.

The pages with revised illustrations have been reproduced on pages 3-6 of this bulletin. Mark the following corrections in the XK8 VSM:

<u>PAGE</u>	<u>STEP</u>	<u>ACTION</u>	
206-03-2	-	Delete: "Caliper socket head bolts"	120 - 160
	-	Insert: "Guide pin"	25 - 30
		Insert: "Bolt - caliper to vertical link"	120 - 160
206-03-4	3.1	Delete: "carrier securing bolt"	
	3.1	Insert: "guide pin"	
	3.2	Delete: "socket head bolts"	
	3.2	Insert: "guide pins"	
206-03-6	13	Delete: Illustration D 206 034	
		Insert: Illustration J 206 073	
	15	Delete: Illustration D 206 036	
		Insert: Illustration J 206 074	
15.2	15.2	Delete: "caliper securing socket head bolts"	
	15.2	Insert: "guide pins"	
15.3	15.3	Delete: "securing bolt"	
	15.3	Insert: "guide pins"	



<u>PAGE</u>	<u>STEP</u>	<u>ACTION</u>	
206-03-7	5.1	Delete:	“caliper to carrier traverse pin dust caps”
	5.1	Insert:	“guide pin covers”
	5.2	Delete:	“caliper to carrier traverse pins”
	5.2	Insert:	“guide pins”
206-03-8	9	Delete:	Illustration D 206 034
	9	Insert:	Illustration J 206 073
206-03-9	11	Delete:	Illustration D 206 041
	11	Insert:	Illustration J 206 074
	11.1	Delete:	“caliper and carrier traverse pin”
	11.1	Insert:	“guide pin”
	11.3	Delete:	“traverse pins”
	11.3	Insert:	“guide pins”
	11.4	Delete:	“traverse pin dust covers”
	11.4	Insert:	“guide pin covers”
206-04-2	-	Delete:	“Caliper socket head bolts” 120 - 160
	-	Insert:	“Guide pin” 26 - 30
			“Bolt - caliper to rear hub carrier” 120 - 160
206-04-4	4.2	Delete:	“caliper to carrier securing bolt”
	4.2	Insert:	“guide pin”
	4.3	Delete:	“socket head bolts”
	4.3	Insert:	“guide pins”
206-04-5	9	Delete:	Illustration D 206 047
	9	Insert:	Illustration J 206 075
	9.3	Delete:	“caliper socket head securing bolts”
	9.3	Insert:	“guide pins”
	9.4	Delete:	“securing bolt”
	9.4	Insert:	“guide pin”

NOTE: There is no change to any Parts or Warranty information

REMOVAL AND INSTALLATION (Continued)

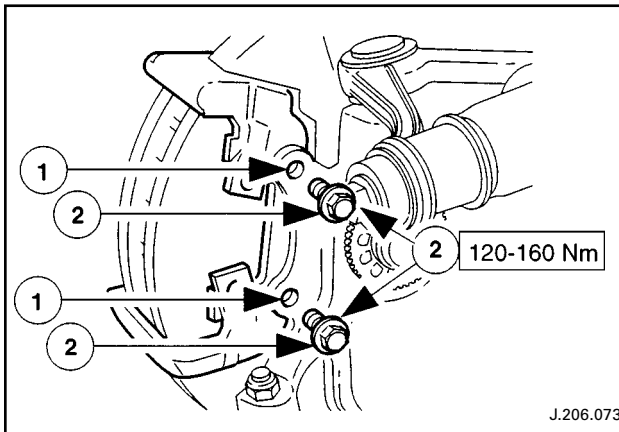

13. Install the caliper carrier.

- 1 Align the caliper carrier and vertical link holes.
- 2 Install and tighten the carrier securing bolts specification.

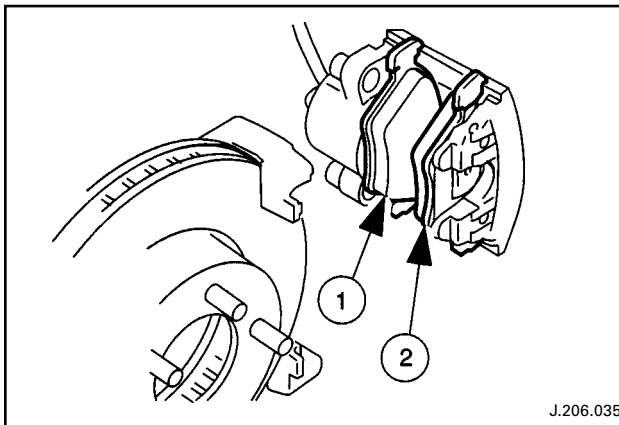

14. Install the brake pads.

- 1 Install and seat the brake pad to caliper piston.
- 2 Install and align the second brake pad.

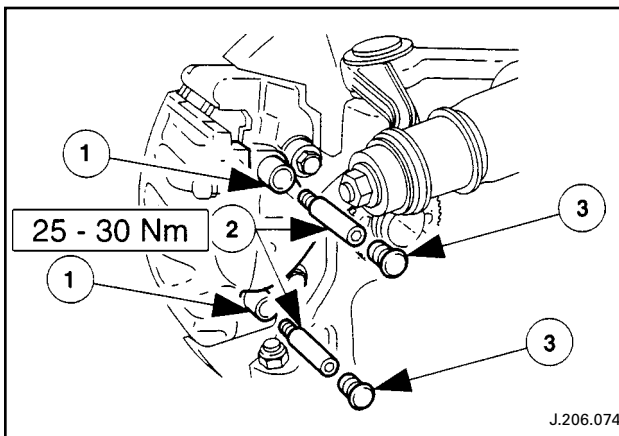

15. Install the caliper on the carrier.

- 1 Align the caliper and carrier bolt holes.
- 2 Install the caliper guide pins and tighten to specification.
- 3 Install the guide pin covers.

16. Install the road wheel; refer to Section 204-04.

17. Lower the vehicle; refer to Section 100-02.

18. Check that the lug nuts are tightened to specification.

19. Start the engine and apply the brake to centralize the caliper and pads with the brake rotor.

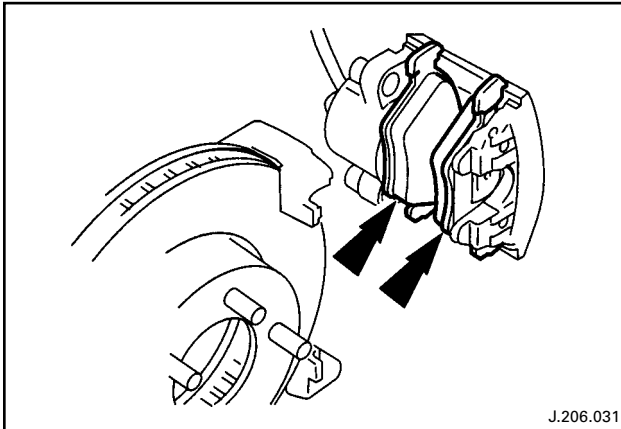
REMOVAL AND INSTALLATION (Continued)

6. Remove the brake pads from the caliper.

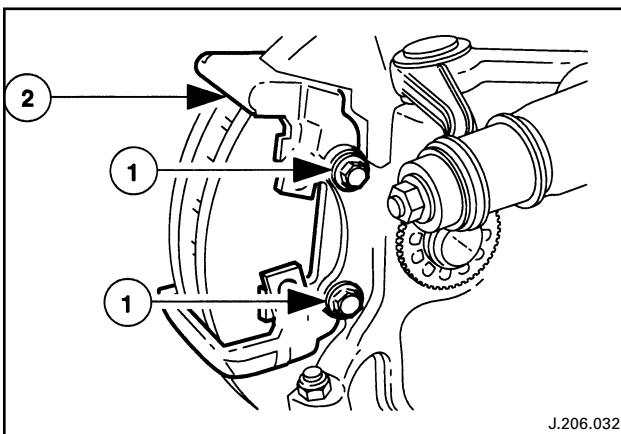

7. Remove the caliper carrier from the vertical link.

- 1 Unscrew the carrier securing bolts.
- 2 Remove the carrier from the vertical link.

WARNING: BRAKE DUST CAN, IF INHALED, DAMAGE YOUR HEALTH. ALWAYS USE A VACUUM BRUSH TO REMOVE DRY BRAKE LINING DUST. NEVER USE AN AIR LINE.

8. Carefully remove brake dust from the brake caliper, carrier, wheel, wheel hub and rotor.

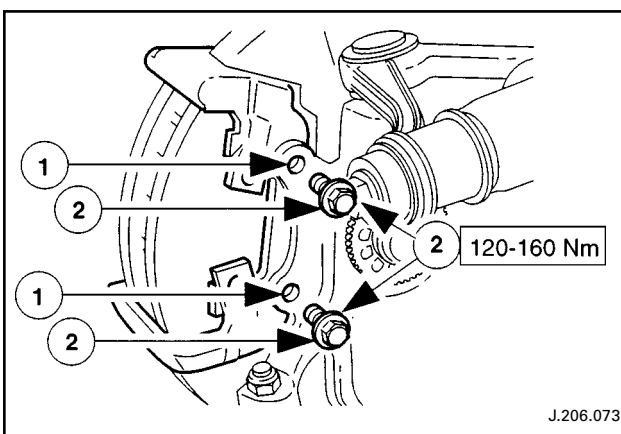
Installation

9. Install the caliper carrier on the vertical link.
 - 1 Align the carrier and vertical link bolt holes.
 - 2 Install the carrier securing bolts and tighten to specification.

REMOVAL AND INSTALLATION (Continued)

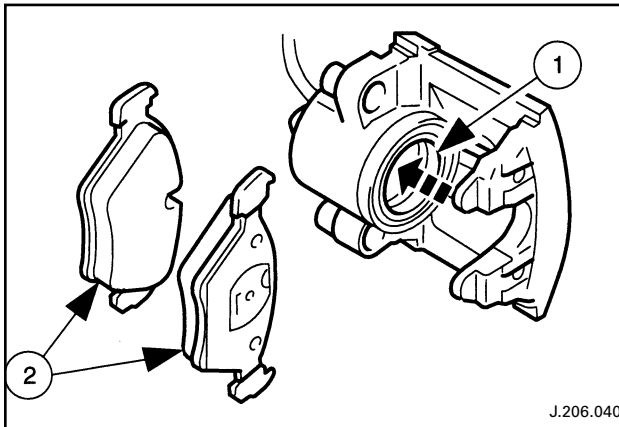

10. Install the brake pads in the caliper.

- 1 Ensure that the caliper piston is fully retracted.
- 2 Install the brake pads in the caliper.

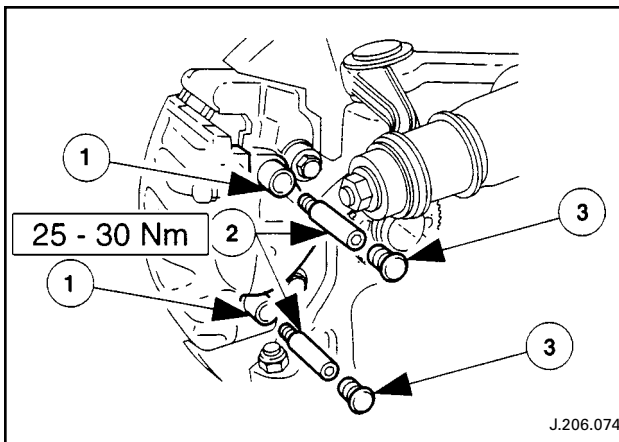

11. Install the caliper on the carrier.

- 1 Align the guide pin holes.
- 2 Install the caliper on the carrier.
- 3 Install the guide pins and tighten to specification.
- 4 Install and fully seat the guide pin covers.

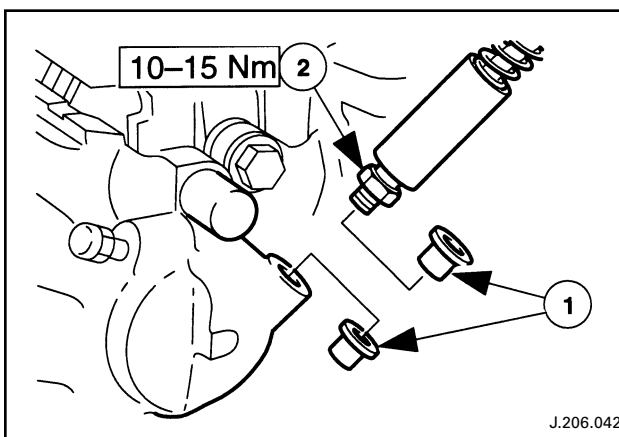

12. Install the feed hose to the caliper.

- 1 Remove the plugs from the feed hose and caliper.
- 2 Align and install the feed hose to the caliper and tighten to specification.

13. Install and fully seat the caliper retaining spring.

14. Install the wheel and tire assembly; refer to Section 204-04.

15. Bleed the ABS hydraulic system; refer to Section 206-06.

16. Lower the vehicle; refer to Section 100-02.

REMOVAL AND INSTALLATION (Continued)

6. Carefully remove brake dust from the brake caliper, carrier, wheel, wheel hub and rotor.

WARNING: BRAKE DUST CAN, IF INHALED, DAMAGE YOUR HEALTH. ALWAYS USE A VACUUM BRUSH TO REMOVE DRY BRAKE DUST. NEVER USE AN AIR LINE.

Installation

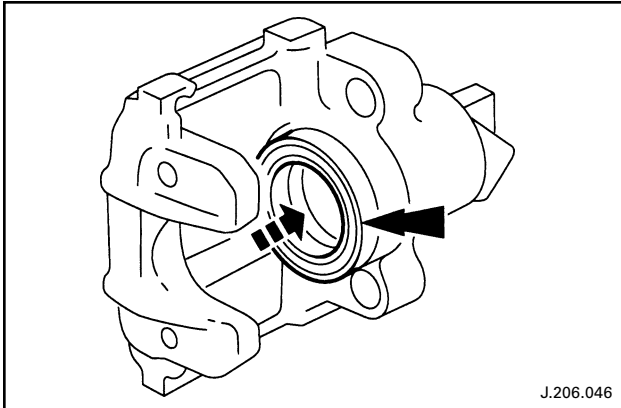

7. Ensure that the piston is fully retracted into the caliper body.

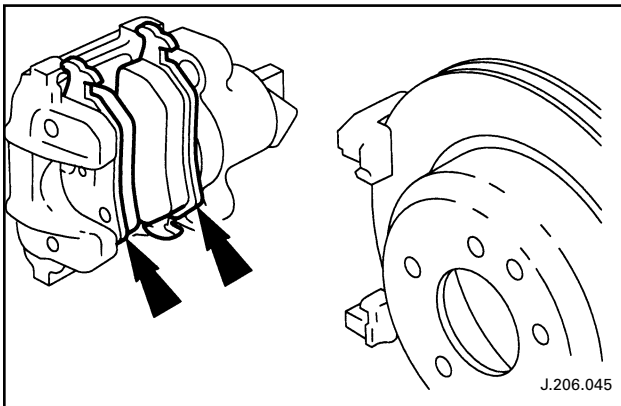

8. Install and align the brake pads to the caliper. **NOTE:** The brake pad with the clip locates in the piston.

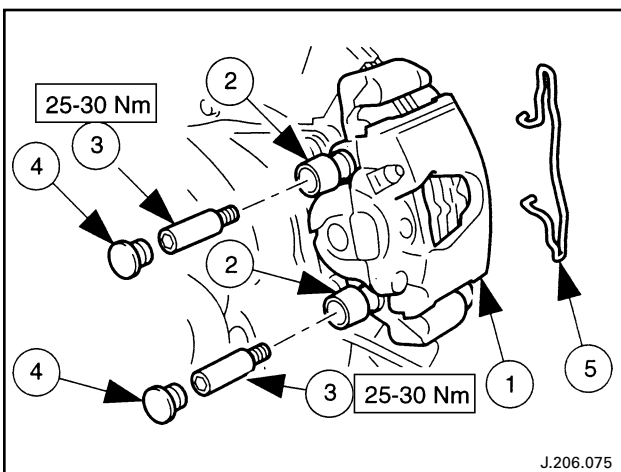

9. Install the caliper and pads assembly.
 - 1 Position the assembly over the brake rotor.
 - 2 Align the caliper and carrier bolt holes.
 - 3 Install the caliper guide pins and tighten to specification.
 - 4 Install and fully seat the guide pin covers.
 - 5 Install and fully seat the caliper retaining spring.